

200 STUYVESANT DR
SAN ANSELMO, CA 94960



Main Level 1,380 SQ FT



Lower Level 1,128 SQ FT

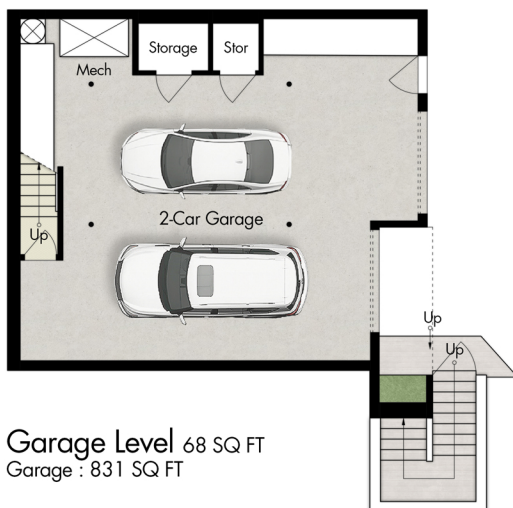

Garage Level 68 SQ FT
Garage : 831 SQ FT

ESTIMATED TOTAL FINISHED SQUARE FOOTAGE: 2,576 SQ FT

Above grade: 2,508 SQ FT

Below grade: 68 SQ FT

Plus 831 SQ FT Garage

Calculated per ANSI Standard Z765-2021

Estimated Total Finished and Unfinished Square Footage: 3,407 SQ FT

